



I. Surface Preparation

All surfaces should be considered dirty and must be cleaned prior to the application of markings. Recommended cleaning procedures for specific surfaces are listed below.

A. Plastics & Glass

Saturate a clean cloth with a 2:1 mixture of water and isopropyl alcohol and wipe the surface. (Cleaners such as Windex Window Cleaner may be used). Wipe the surface dry with a clean, dry, lint-free cloth.

B. Painted Metals and Base Metals

These surfaces must be cleaned with a solvent such as: E.I. DuPont Prep-Sol Cleaning Solvent 39195, XyloI, VM&P Naphtha, or Lacquer Thinner. Dry the surface with a lint-free cloth before the solvent evaporates. Freshly painted surfaces must be allowed to dry for one week prior to application.

C. Interior Painted Surfaces

Paint must be allowed to dry one week prior to application of markings. Clean the area where the markings are to be applied with a household cleaner such as 409. Rinse thoroughly and dry. Paint surface should be semi gloss or gloss. Matte surface is not recommended.

II. Temperature Requirements

Air and application surface temperatures must be above 40°F for vinyl products and 55°F for reflective products.

III. Application Instructions

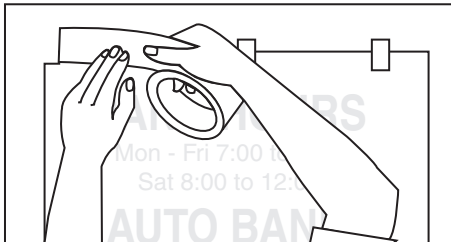

A. Use 1"-2" (2.5-5 cm) strips of masking tape to position graphic. Apply horizontal tape hinge to top of graphic.



B. Lift graphic and remove back liner.

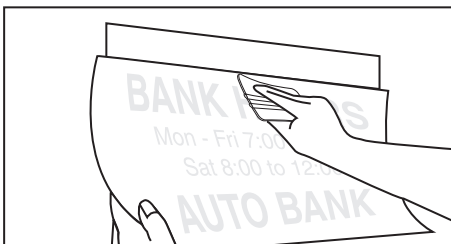

C. Allow graphic to drape. Using firm initial squeegee pressure, begin at top center and work down and outward to each edge of mask.

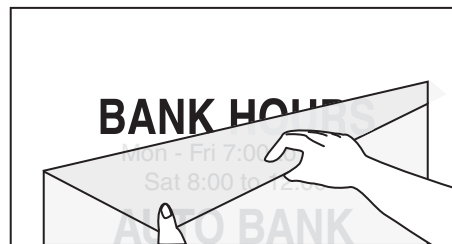

D. Remove premask at 180° (pull back on itself).

E. Resqueegee entire graphic carefully to prevent loose edges.

Important Notice to Purchaser: All statements, technical information and recommendations herein are based on tests we believe to be reliable, but the accuracy or completeness thereof is not guaranteed, and the following is made in lieu of all warranties, expressed or implied, including the implied warranties of merchantability and fitness for purpose: Seller's and manufacturer's only obligation shall be to replace such quantity of the product proved to be defective. Before using, user shall determine the suitability of the product for its intended use, and user assumes all risk and liability whatsoever in connection therewith. NEITHER SELLER NOR MANUFACTURER SHALL BE LIABLE EITHER IN TORT OR IN CONTRACT FOR ANY LOSS OR DAMAGE, DIRECT, INCIDENTAL, OR CONSEQUENTIAL, ARISING OUT OF THE USE OF OR THE INABILITY TO USE THE PRODUCT. No statement or recommendation not contained herein shall have any force or effect unless in an agreement signed by officers of seller and manufacturer.